

Real Estate Information

Selling land

Type	Kitabukuro-achi (Yuwaku area) selling land				
Price	Price	Per Tsubo	Primary school		
	500 man JPY	3.4 man JPY	Yuwaku-Cho		
Address	Kanazawa-shi Kitabukuro-machi RI 3 7 ban 5		Junior high		
			Shibahara-Chu		
Chiban	Ri 3 7 ban 5、Hi 1 9 ban 2 5				
Zone	Urbanization area (new construction OK)				
L A N D	Area	by Public book	542.37 m ²	title	Ownership
			164.06 Tsub.	BCR	building coverage ratio : 60%
	category	residential land		FAR	floor area ratio : 100%
	Current	empty		Delivery	Present condition
R O A D	width	east	4.9m	type	Kanazawa City road
		frontage	18.5m	pavement	done
	transportation	Hokutetsu-Bus KitabukuroBS 5min walk	near places	Post office : 1,604m	
	To Kenrokuen 24min by car	Yuwaku Onsen : 1856m			
	AEON Morinosato 15min by car	Nnursery school :1,311m			
C o m m e n t	Rural scenery with a field of view of 180 degrees spreading in front of you. A new life in nature that looks at the wind, the green and the river.	Water supply system			
		Kanazawa City Water			
		Sewer system			
		Kanazawa City Water			
		Gas line			
		No city gas / Propane gas			
P u b l i c M a p	Set back due to cliff				
					

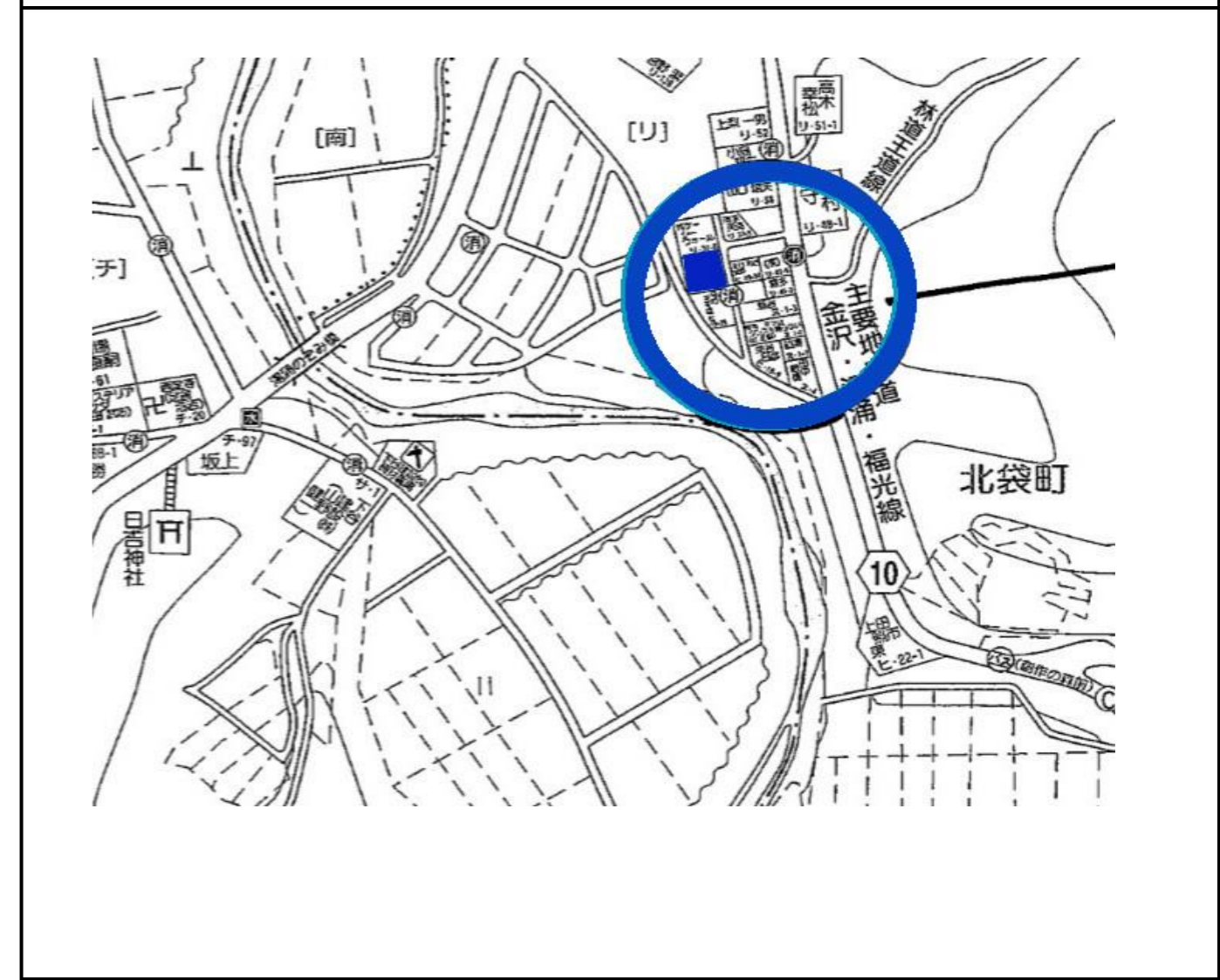
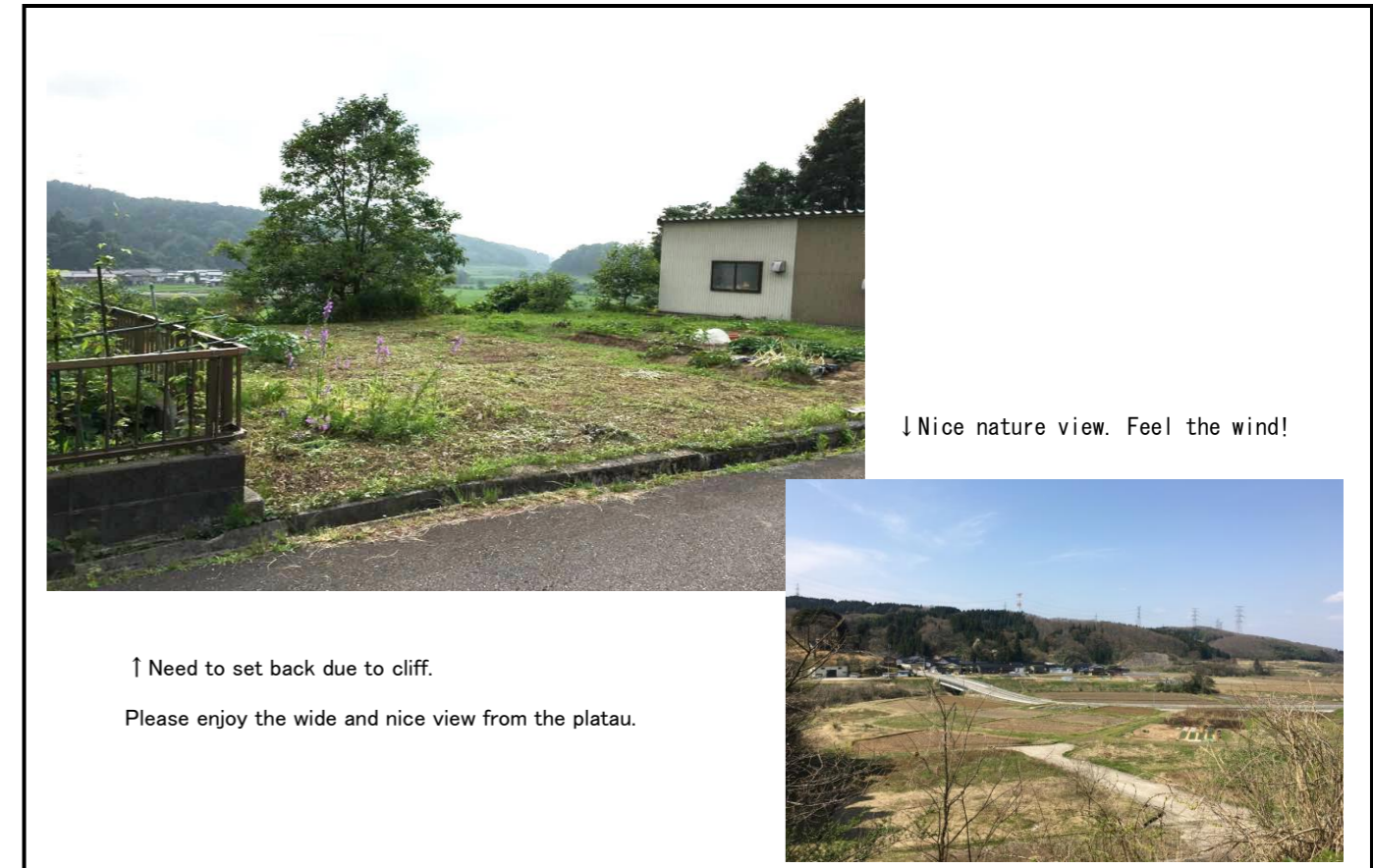

Monsoon Planning Inc.

1-2-32 Owari-cho, Kanazawa, Ishikawa, Japan #920-0902

info@monsoonplanning.com

Qualification

Ishikawa Prefecture Governor's License (1) No. 4178